

**Thanks to all those that contributed to the
planning, design and construction of Liberty Middle School.
We would like to recognize:**

The Community of Newark,
without your support the dream would have never begun.

The construction of Legend Elementary and Liberty Middle School was made possible by the generous donation of 30 acres of land by **The Thomas J. Evans Foundation.**

Master Plan Steering Committee

| | |
|------------------|-----------------|
| Fontella Johnson | Ron Strong |
| Diane Green | Teresa Strong |
| Veva Villinger | Roger Loomis |
| Tamara Schmitt | Philip Rainbolt |
| Earlene Holman | Rebecca Cates |
| Jana VanDack | Ann Sayers |
| Paddy Kutz | Diane Watson |
| Nate Voris | Sheila Hiles |
| Shirley Stare | Jeff Harris |
| Donna Maines | Patricia Denune |
| Donna Ellis | Jane Marstella |
| Tim Matheny | Mya Kluisza |
| Mike Martin | Debbie Henson |
| Curtis Dykes | Gayle Waite |
| Dan DeLawder | Spencer Null |
| Ray Kress | Terry Crayton |
| Elizabeth Welch | Tina Franks |
| Norman Sleight | Nick Myers |
| Don Ellington | Tanny Lumbatis |
| Linda Brown | David Sims |
| Layli Keyse | Eva Marino |
| Barb Quackenbush | Kristi Woolard |
| Dreama Hughes | Kim Huffman |
| Julie Kroah | Judy McNeish |
| Kathleen Erhard | |

Bond Campaign Committee

| | |
|--------------------|----------------|
| Dave Altepeter | Paddy Kutz |
| Jeremy Blake | Tanny Lumbatis |
| Mabel Broughton | Jim Mitchell |
| D.M. Caldwell | Barry Moore |
| Mark Christenberry | Jerry Nethers |
| Tracy Ellington | Cal Roebuck |
| Diane Green | Gary Walters |
| Dana Herreman | Ed Ware |
| Cheri Hottinger | Bill Weidaw |
| J.D. Kreager | |

Middle School Design Team Committee

| | |
|------------------|---------------------|
| Karla Anderson | Katherine Orner |
| John Davis | Diana Patrick |
| Dana Herreman | Elizabeth Phelps |
| Sheila Hiles | David Pintz |
| Patricia Johnson | Robert Steinbrecher |
| Arthur Martin | Sandra Stoker |
| Richard Nabors | Rita Vermaaten |

Board of Education

Robert Handelman, President
Molly Ingold, Vice-President
Jeremy Blake, Member
Thomas Bline, Member
Mike Hendershot, Member
Karen Kreager, Member
David Paul, Member
Nathan Voris, Member
Keith Richards, Superintendent
Dan Montgomery, Asst. Superintendent
Julie Taylor, Treasurer
Brian Wilson, Treasurer

City of Newark

Bruce Bain, Mayor
Kathleen Barch, Safety Director
David Calhoun, Director of Public Service
Greg Coffman, Newark Fire Department Inspector
Jay Finklea, Zoning Inspector
Stephen Fowler, Economic Development Director
Thomas Gall, Plans Examiner, Commercial
Roger Loomis, Utilities Director
Brian Morehead, City Engineer
William Powell, Newark Fire Department Inspector
Jack Pryor, Chief Building Code Administrator

Contractors

RW Setterlin Building Company, Sitework
Robertson Construction Services, Inc., General Trades
Gutridge Plumbing, Inc., Fire Protection
Johnson Controls, Inc., Temperature Controls
Farnham Equipment Company, Casework
Houston Plumbing & Heating, Inc., HVAC & Plumbing
Hilscher-Clarke Electric Company, Electrical
Microman, Inc., Technology

Consultants

Legat & Kingscott, LLC, Architect & Interior Design
JBA Architects, PC, Associate Architect
M-Engineering, Structural, Mechanical, Plumbing,
Electrical & Technology Engineer
Jobs-Henderson & Assoc. Inc., Civil Engineer
Baker Group, Food Service Consultant
Resource International, Inc., Construction Manager



The traditions begin...

Liberty Middle School

**Ribbon-Cutting
& Open House
August 20, 2007**

Welcome & Introduction
Keith Richards

Speakers
*Charles Nelson, Legat & Kingscott
Robert Hart, Resource International*

Recognition of Contributors

Ribbon-Cutting
*Keith Richards,
Elizabeth Athey, Paige Cashin,
William Schwartz, Duncan Unternaher*

Closing, Refreshments & Tour

Building Design

The exterior of the building is designed to blend with the architectural heritage of the community. The same exterior materials were used on it and the adjacent new elementary (Legend Elementary) in order to create a cohesive campus setting.

The two-story school is organized utilizing grade-level wings connected to a main street. This main street accommodates the large assembly spaces and the mutually-used areas including the gym, locker rooms, media center, administrative and counseling offices, music room, stage and dining area.

Artwork

Bowerston Shale Company graciously donated a brick sculpture that is located in the main entrance of the facility. The piece, sculpted by local artist, Allen Moran, embodies the heritage of Newark.

Building Facts

Location: 1055 Evans Boulevard
Site Acreage: 30 Acres
Student Capacity: 450
Grade Configuration: 6-8
Total Size: 69,922 Square Feet

Academics

- 28 teaching stations.
- Standard classrooms are 875 square feet. Other spaces include:
 - Science Rooms, Computer Lab, Art, Music, Special Education, Project Lab, Life Skills, Industrial Technology
 - Media Center - 1,515 square feet
 - Gymnasium - 6,645 square feet
- Wireless technology capability available throughout the building.
- The sixth grade students will be located on the first floor with seventh and eighth grade students on the second floor.

First Floor

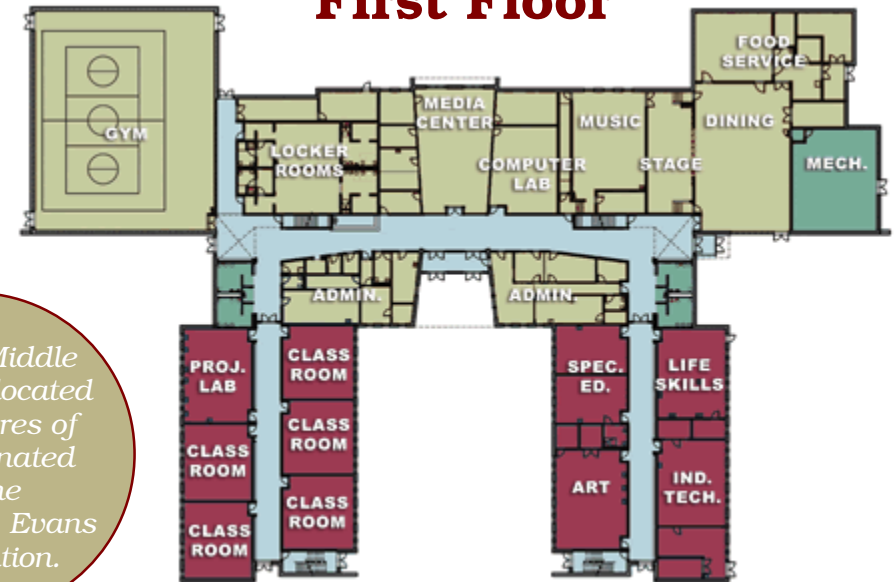

Liberty Middle School is located on 30 Acres of Land donated by the Thomas J. Evans Foundation.

60% of the material and labor was provided by local companies.

District-wide master plan to be 51% state funded.

Second Floor

